



77F-200 SERIES

FULL PORT SOLDER END

BRASS BALL VALVE



Job Name:	Contractor:
Job Location:	P.O. Number:
Engineer:	Representative:
Tag:	Wholesale Distributor:

DESCRIPTION

The Apollo 77F-200 series is a full port forged brass ball valve suitable for a wide range of plumbing and heating applications. This valve is designed to be soft soldered into lines without disassembly. Proudly Made in the USA.

FEATURES

- Heavy Pattern Forged Design
- Full-Port Flow
- Superior RPTFE Seats and Packing
- Adjustable Stem Packing
- Blow-Out Proof Stem
- Corrosion Resistant Materials
- 100% Factory Tested
- Silicone Free Assembly
- **Made in USA**, ARRA Compliant

PERFORMANCE RATING

- Valve Design Rating: 600 CWP
- Temperature Range: 0°F - 400°F

APPROVALS

- MSSP-SP-110 Ball Valves
- IAPMO IGC-157 Ball Valves
- NSF/ANSI 61 Section 8
- FM 1140

MATERIAL SPECIFICATIONS

Part Name	Material
Body	Brass, ASTM B283 alloy C37700
Seat	RPTFE
Ball	Brass, ASTM B16, C36000 Chrome Plated
Stem Packing	RPTFE
Nut	Corrosion Resistant Plated Steel
Stem	Brass, ASTM B16, C36000
Retainer	Brass, ASTM B283 alloy C37700
Handle	Plated Steel / Insulated Polyvinyl
Gland	Brass, ASTM B16, C36000

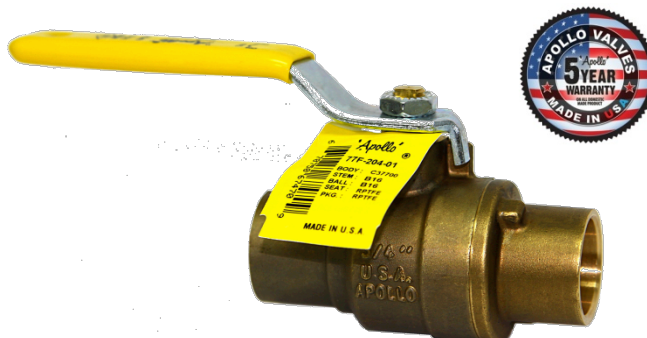

DIMENSIONS (in)

Part No.	Size	A	B	C	D	E	Wt. (lbs.)
77F20301	1/2"	0.50	1.37	2.37	1.66	2.85	0.4
77F20401	3/4"	0.75	1.72	3.13	1.91	3.86	0.9
77F20501	1"	1.00	2.01	3.73	2.11	3.86	1.3
77F20601	1-1/4"	1.25	2.07	3.97	2.44	4.75	2.0
77F20701	1-1/2"	1.50	2.42	4.69	2.91	5.42	3.3
77F20801	2"	2.00	2.91	5.82	3.69	7.77	5.6

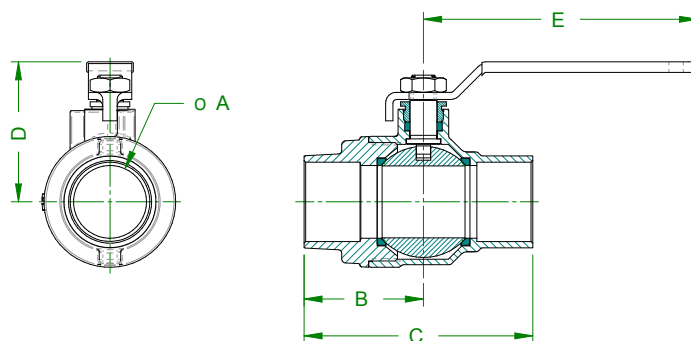

OPTIONS

- ☐ (-01) Standard Lever
- ☐ (-04) 2 1/4" Stem Extension
- ☐ (-07) Tee Handle
- ☐ (-11) Thermo-Seal™ Insulating Tee Handle
- ☐ (-27) Locking Handle
- ☐ 77F240 Series – SS Ball & Stem
- ☐ 77FLF Series – Lead Free 0.25% max



Conbraco Industries, Inc. 701 Matthews Mint Hill Rd. Matthews NC 28106 USA; www.apollovalves.com ; 704-841-6000

This specification is provided for reference only. Conbraco reserves the right to change any portion of this specification without notice and without incurring obligation to make such changes to Conbraco products previously or subsequently sold.