



# 70-100-HC SERIES

## Bronze NPT x 3/4" Hose Connection With Cap & Chain

Job Name:	Contractor:
Job Location:	P.O. Number:
Engineer:	Representative:
Tag:	Wholesale Distributor:

### DESCRIPTION

The Apollo® 70100HC Series is ideally suited for direct connection to hoses. Valve contains a securely attached cover with chain which prevents damage to hose threads.

### FEATURES

- Stainless Steel Lever & Nut
- Blow-Out-Proof Stem Design
- Adjustable Packing Gland
- RPTFE Seats and Stuffing Box Ring
- Cap & Chain protects hose threads
- Heavy brass cap is full pressure rated
- Reverse Handle
- NPT x 3/4" NPSH
- Manufactured and 100% Factory Tested in the USA

### PERFORMANCE RATING

- Maximum Pressure: 600 psi CWP
- Vacuum Service to 29 in. Hg



### DIMENSIONS

PART #	SIZE	A	B	C	D	E	F	WT
70103HC	1/2"	0.50	1.09	2.75	2.99	1.94	4.18	0.63
70104HC	3/4"	0.68	1.50	3.41	3.66	2.32	5.31	1.30
70105HC	1"	0.87	1.67	3.92	4.16	2.43	5.31	2.11

### STANDARD MATERIALS LIST

Part Name	Material
Lever and Grip	Stainless Steel w/ Vinyl
Stem Packing	MPTFE
Stem Bearing	RPTFE
Ball	B16, Chrome Plated
Seat (2)	RPTFE
Retainer	B16 Brass
Gland Nut	B16 Brass
Stem	B16 Brass
Lever Nut	Stainless Steel
Body	B584-C84400

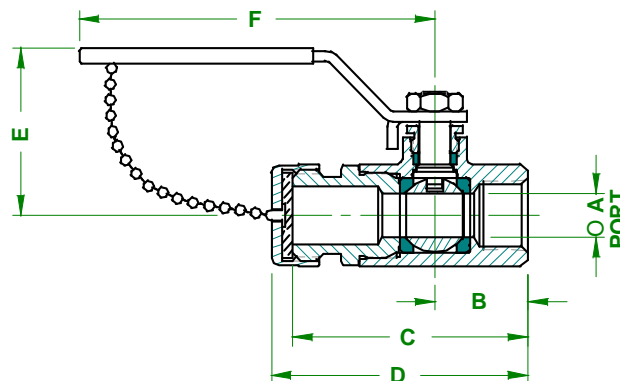

### APPROVALS

- MSS SP-110; Ball Valves Threaded, Socket-Welding, Solder Joint, Grooved and Flared Ends

### OPTIONS

<input type="checkbox"/> (-03) 1 1/4" CS Stem Extension	1/2" - 1"
<input type="checkbox"/> (-04) 2 1/4" CS Stem Extension	1/2" - 1"
<input type="checkbox"/> (-07) Steel Tee Handle	1/2" - 1"
<input type="checkbox"/> (-11) Therma-Seal™ Insulating Tee Handle	1/2" - 1"
<input type="checkbox"/> (-15) Wheel Handle, Steel	1/2" - 1"
<input type="checkbox"/> (-27) SS Latch-Lock Lever & Nut	1/2" - 1"
<input type="checkbox"/> (-93) 1-1/4" Extension w/ Balancing stop	1/2" - 1"
<input type="checkbox"/> (-94) 2-1/4" Extension w/ Balancing stop	1/2" - 1"
<input type="checkbox"/> 70-140-HC Series - 316 SS Ball & Stem	1/2" - 1"

Conbraco Industries, Inc. 701 Matthews Mint Hill Rd. Matthews NC 28106 USA; [www.apollovalves.com](http://www.apollovalves.com) ; 704-841-6000

This specification is provided for reference only. Conbraco reserves the right to change any portion of this specification without notice and without incurring obligation to make such changes to Conbraco products previously or subsequently sold.